

Volantino 7 punte con Boccola Ottone Filettata Star Knob, 7 Points, Threaded Blind Insert

V7B series

Caratteristiche

Materiale Corpo:

Phenoplasto rinforzato di colore Nero, resistente a solventi, oli, grassi ed altri agenti chimici

Parte Metallica e/o

Fissaggio:

Boccola in ottone con foro cieco filettato

Product specification

Main Part Material:

Black Phenoplast, solvents, oils, greases and other chemical agents proof

Metallic Part Material &

Finishing:

Brass Insert, Threaded Blind Hole

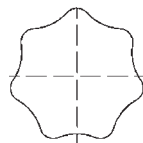
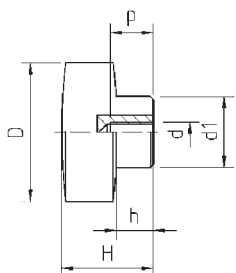

| Codice | D | d | d1 | H | h | P | Peso grammi Weight gr | Confezione Pz Packing Pcs. |
|-----------|----|------|----|----|----|----|--------------------------|-------------------------------|
| B1V7B3004 | 30 | 04MA | 17 | 23 | 10 | 8 | 15 | 20 |
| B1V7B3005 | 30 | 05MA | 17 | 23 | 10 | 10 | 15 | 20 |
| B1V7B3006 | 30 | 06MA | 17 | 23 | 10 | 12 | 16 | 20 |
| B1V7B3008 | 30 | 08MA | 17 | 23 | 10 | 16 | 17 | 20 |
| B1V7B4006 | 40 | 06MA | 21 | 27 | 11 | 12 | 30 | 20 |
| B1V7B4008 | 40 | 08MA | 21 | 27 | 11 | 16 | 33 | 20 |
| B1V7B4010 | 40 | 10MA | 21 | 27 | 11 | 16 | 33 | 20 |
| B1V7B5006 | 50 | 06MA | 25 | 35 | 15 | 12 | 57 | 20 |
| B1V7B5008 | 50 | 08MA | 25 | 35 | 15 | 16 | 59 | 20 |
| B1V7B5010 | 50 | 10MA | 25 | 35 | 15 | 22 | 61 | 20 |
| B1V7B5012 | 50 | 12MA | 25 | 35 | 15 | 22 | 68 | 20 |
| B1V7B6008 | 60 | 08MA | 28 | 39 | 18 | 16 | 85 | 20 |
| B1V7B6010 | 60 | 10MA | 28 | 39 | 18 | 22 | 88 | 20 |
| B1V7B6012 | 60 | 12MA | 28 | 39 | 18 | 22 | 93 | 20 |
| B1V7B6014 | 60 | 14MA | 28 | 39 | 18 | 22 | 98 | 20 |
| B1V7B7010 | 70 | 10MA | 30 | 42 | 18 | 22 | 121 | 20 |
| B1V7B7012 | 70 | 12MA | 30 | 42 | 18 | 22 | 127 | 20 |
| B1V7B7014 | 70 | 14MA | 30 | 42 | 18 | 22 | 133 | 20 |
| B1V7B7016 | 70 | 16MA | 30 | 42 | 18 | 22 | 138 | 20 |
| B1V7B8012 | 80 | 12MA | 32 | 53 | 28 | 22 | 186 | 20 |
| B1V7B8014 | 80 | 14MA | 32 | 53 | 28 | 22 | 186 | 20 |
| B1V7B8016 | 80 | 16MA | 32 | 53 | 28 | 22 | 187 | 20 |

V7BP series

Caratteristiche

Materiale Corpo:

Phenoplasto rinforzato di colore Nero, resistente a solventi, oli, grassi ed altri agenti chimici

Parte Metallica e/o Fissaggio:

Boccola in ottone con foro passante filettato

Product specification

Main Part Material:

Black Phenoplast, solvents, oils, greases and other chemical agents proof

Metallic Part Material & Finishing:

Brass Insert, Threaded Thru-Hole

Volantino 7 punte con Boccola Ottone Filettata Passante Star Knob, 7 Points, Threaded Thru-Insert

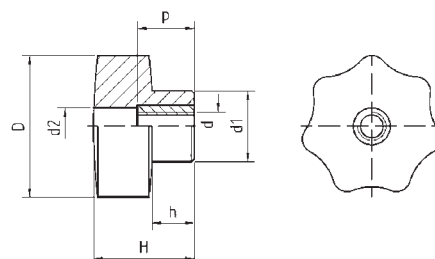

| Codice | D | d | d1 | d2 | H | h | P | Peso grammi Weight gr | Confezione Pz Packing Pcs. |
|------------|----|------|----|------|----|----|----|--------------------------|-------------------------------|
| B1V7BP3004 | 30 | 04MA | 17 | 10 | 23 | 10 | 15 | 13 | 20 |
| B1V7BP3005 | 30 | 05MA | 17 | 10 | 23 | 10 | 15 | 14 | 20 |
| B1V7BP3006 | 30 | 06MA | 17 | 10 | 23 | 10 | 15 | 15 | 20 |
| B1V7BP3008 | 30 | 08MA | 17 | 10 | 23 | 10 | 15 | 16 | 20 |
| B1V7BP4006 | 40 | 06MA | 21 | 10,5 | 27 | 11 | 20 | 35 | 20 |
| B1V7BP4008 | 40 | 08MA | 21 | 10,5 | 27 | 11 | 20 | 31 | 20 |
| B1V7BP4010 | 40 | 10MA | 21 | 10,5 | 27 | 11 | 20 | 32 | 20 |
| B1V7BP5008 | 50 | 08MA | 25 | 12,5 | 35 | 15 | 20 | 57 | 20 |
| B1V7BP5010 | 50 | 10MA | 25 | 12,5 | 35 | 15 | 20 | 58 | 20 |
| B1V7BP5012 | 50 | 12MA | 25 | 12,5 | 35 | 15 | 20 | 61 | 20 |
| B1V7BP6008 | 60 | 08MA | 28 | 14 | 39 | 18 | 20 | 73 | 20 |
| B1V7BP6010 | 60 | 10MA | 28 | 14 | 39 | 18 | 20 | 82 | 20 |
| B1V7BP6012 | 60 | 12MA | 28 | 14 | 39 | 18 | 20 | 85 | 20 |
| B1V7BP7010 | 70 | 10MA | 30 | 19 | 42 | 18 | 26 | 113 | 20 |
| B1V7BP7012 | 70 | 12MA | 30 | 19 | 42 | 18 | 26 | 116 | 20 |
| B1V7BP7014 | 70 | 14MA | 30 | 19 | 42 | 18 | 26 | 121 | 20 |
| B1V7BP7016 | 70 | 16MA | 30 | 19 | 42 | 18 | 26 | 115 | 20 |
| B1V7BP8012 | 80 | 12MA | 32 | 17 | 53 | 28 | 26 | 170 | 20 |
| B1V7BP8016 | 80 | 16MA | 32 | 17 | 53 | 28 | 26 | 167 | 20 |

V7L series

Caratteristiche

Materiale Corpo:

Phenoplasto rinforzato di colore Nero, resistente a solventi, oli, grassi ed altri agenti chimici

Parte Metallica e/o Fissaggio:

Boccola in ottone con foro cieco liscio

Product specification

Main Part Material:

Black Phenoplast, solvents, oils, greases and other chemical agents proof

Metallic Part Material & Finishing:

Brass Insert, NonThreaded Blind Hole

Volantino 7 punte con Boccola in Ottone Liscia Star Knob, 7 Points, Non-Threaded Blind Insert

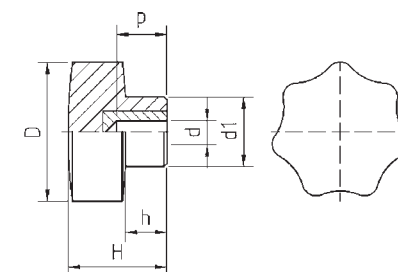

| Codice | D | d | d1 | H | h | P | Peso grammi Weight gr | Confezione Pz Packing Pcs. |
|-----------|----|----|----|----|----|----|--------------------------|-------------------------------|
| B1V7L3006 | 30 | 6 | 17 | 23 | 10 | 12 | 8 | 20 |
| B1V7L3008 | 30 | 8 | 17 | 23 | 10 | 16 | 9 | 20 |
| B1V7L4008 | 40 | 8 | 21 | 27 | 11 | 16 | 37 | 20 |
| B1V7L4010 | 40 | 10 | 21 | 27 | 11 | 18 | 37 | 20 |
| B1V7L5008 | 50 | 8 | 25 | 35 | 15 | 16 | 66 | 20 |
| B1V7L5010 | 50 | 10 | 25 | 35 | 15 | 22 | 73 | 20 |
| B1V7L6010 | 60 | 10 | 28 | 39 | 18 | 24 | 103 | 20 |
| B1V7L6012 | 60 | 12 | 28 | 39 | 18 | 24 | 103 | 20 |
| B1V7L7012 | 70 | 12 | 30 | 42 | 18 | 24 | 142 | 20 |